



## Butane Torch Lighter Inserts

English USA – en

Single Torch Model #Z8A19

Double Torch Model #Z8B19

### FILLED TORCH INSERT WARNINGS:

**WARNING: KEEP LIGHTER AND THEIR FUELS OUT OF REACH OF CHILDREN.** Ignite lighter away from face and clothing. Be sure flame is out after use. Contains flammable gas under pressure. Never expose to heat above 50°C (122°F) or to prolonged sunlight. Never puncture or put in fire. Extreme heat is present above the visible flame. Extra care should be taken to prevent burn, injury or fire. Do not keep lit for more than 10 seconds. Do not refuel over containers such as sinks or near a flame. Butane tends to settle and collect in the lowest point.



### EMPTY TORCH INSERT WARNINGS:

**WARNING: KEEP LIGHTER AND THEIR FUELS OUT OF REACH OF CHILDREN.** Ignite lighter away from face and clothing. Be sure flame is out after use. When filled, will contain flammable gas under pressure. Never expose to heat above 50°C (122°F) or to prolonged sunlight. Never puncture or put in fire. Extreme heat is present above the visible flame. Extra care should be taken to prevent burn, injury or fire. Do not keep lit for more than 10 seconds. Do not refuel over containers such as sinks or near a flame. Butane tends to settle and collect in the lowest point.

© Zippo Manufacturing Company 2021.

181905\_rC

Thank you for purchasing the ZIPPO® BUTANE TORCH LIGHTER INSERT ("Product"). **READ ALL WARNINGS AND INSTRUCTIONS** before using your Product for the first time. Improper use of this Product may result in Product damage, for which damages you ("Purchaser") and not Zippo Manufacturing Company ("Zippo") are responsible.

If you have any problems with the operation of your Product, **DO NOT return it to the retail store.** Instead, consumers in the U.S. should contact Zippo Consumer Relations at 888-442-1932 or visit [zippo.com](http://zippo.com)

**WARNING:** Read all safety warnings and instructions. Failure to follow the warnings and instructions may result in Product damage and/or serious injury. Extra care should be taken to prevent burn, injury, or fire. Save these instructions for future reference.

### GENERAL SAFETY WARNINGS AND INSTRUCTIONS:

- Keep lighters and their fuels out of reach of children.
- Ignite lighter away from face and clothing.
- Be sure flame is out after use.
- When filled, will contain flammable gas under pressure.
- Use butane fuel only.
- DO NOT refuel over containers such as sinks or near a flame. Butane tends to settle and collect in the lowest point.
- Fill or refill in a well-ventilated area.
- Hold insert or lighter away from face.
- Use Zippo® or Ronson® butane fuel for best performance.
- For safe refilling: ensure proper mating between refill can nozzle and lighter filling valve.
- Wait at least 2 minutes after refilling before using the insert.
- DO NOT keep lit for more than 10 seconds.
- Never expose to heat above 50°C (122°F) or to prolonged sunlight.
- Never puncture or put in fire.

### TWO YEAR LIMITED WARRANTY

Zippo Manufacturing Company warrants the Product against manufacturing defects in material and workmanship under normal use. This warranty does not cover, and Zippo shall have no liability with respect to, damage, failure or loss caused by or attributable to abuse, accident, misuse, improper or abnormal use, neglect, improper or unauthorized repair, failure to follow instructions provided by Zippo or "acts of God" or other contingencies beyond the control of Zippo. This warranty does not cover the incidental or consequential damages, although some states do not allow the exclusion or limitation of incidental or consequential damages, so the above limitation or exclusion may not apply to you.

Warranty coverage extends to the original purchase and begins on the date of purchase and ends two (2) year thereafter. Other than as to the foregoing, this warranty is in lieu of all other express and implied warranties. Any implied warranties which by law cannot be excluded are limited to this same period. Some states do not allow limitations on how long an implied warranty lasts, so the above limitation may not apply to you. This warranty gives you specific legal rights, and you may also have other rights which vary from state to state. To obtain proper instructions for service under this limited warranty, refer to repair instructions at [zippo.com](http://zippo.com) or contact Zippo Consumer Relations at [consumerrelations@zippo.com](mailto:consumerrelations@zippo.com) or 1-888-442-1932. **Do not return the Product to the retail store.** If the Product is covered by the warranty, Zippo will repair or replace the item or will refund the purchase price. Any attempt to disassemble the Product by user or any non-approved repair center will void this warranty.

*NOTE: Proof of purchase is required for warranty service.*

#### ZIPPO MANUFACTURING COMPANY

33 Barbour Street | Bradford, PA 16701 U.S.A.

- Extreme heat is present above the visible flame. Flame may NOT be visible in bright light.
- DO NOT point lighter towards face.
- This insert is only designed to work with regular-sized genuine Zippo Windproof Lighter models including; Regular, Vintage, Armor®, and 1941 Replica.
- DOES NOT work with Slim or 1935 Replica models.
- DO NOT attempt to disassemble the Product for cleaning or modify it in any manner. This will void the warranty.
- Always grasp lighter case edge(s) with finger(s) and thumb when inserting or removing butane insert. Gripping face of lighter may cause difficulty.
- Follow all instructions and warnings provided by manufacturer of any other item when using this product.

### DISCLAIMER:

ZIPPO WILL NOT BE RESPONSIBLE OR LIABLE FOR ANY DAMAGES YOU OR ANY THIRD PARTY MAY SUFFER AS A RESULT OF USE OR MISUSE OF THIS PRODUCT.

### Butane Torch Lighter Insert

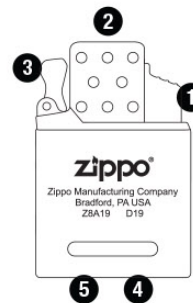

1. Ignition Button
2. Flame
3. Cam
4. Butane Filling Valve
5. Flame Adjuster

### OPERATING INSTRUCTIONS:

#### Install the Insert into your Zippo Lighter Case

- Carefully remove insert from package.
- If unfilled, see Butane Filling Instructions below.
- Open lighter lid and remove lighter insert.
- Firmly grasp lighter case edge(s) with finger(s) and thumb, then slide new torch insert into lighter case.
- Be sure to flip insert cam down before inserting into lighter case.

#### Ignition

- Open the lid.
- Press down firmly on ignition button with thumb and hold to ignite flame. **WARNING – DO NOT keep lit for more than 10 seconds.**
- Release ignition button to extinguish flame.

### Butane Filling Instructions

- Some inserts are shipped filled with butane or empty without fuel. If the insert is filled it's ready for use. If empty, follow instructions below.
- Always fill with Zippo® or Ronson® butane fuel for best performance.
- Always fill the butane insert in the upside down position.
- Fill or refill in a well-ventilated area.
- Hold insert or lighter away from face.
- Read all warnings on butane canister prior to filling.
- For safe refilling: ensure proper mating between refill can nozzle and lighter filling valve.
- Firmly press butane can tip downward into inlet filling valve for 6 seconds.
- Wait at least 2 minutes after refilling before using the insert. This allows for excess gas to evaporate and the butane in the insert to stabilize.

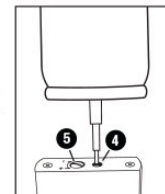

### Flame Adjustment

- Turn adjuster to (+) for higher flame, (-) for lower flame.

### Performance Tips

- Like all butane lighters, the performance of this lighter insert is affected by high altitudes over 5,000 feet (1,500 meters). For optimum performance, always use Zippo® or Ronson® butane fuel. Use of other brands may result in clogging and poor ignition rate, especially at high altitudes and below-freezing temperatures.
- All butane lighters must be kept above freezing in order to operate. Storing lighter insert in an inner pocket or warming it in your hand for a few minutes will enable the lighter to be used at cold temperatures.

ZIPPO MANUFACTURING COMPANY  
33 Barbour Street  
Bradford, PA 16701 U.S.A.

[zippo.com](http://zippo.com)