



## Double Heated Seat

English USA – en

Model #Z5B23

### IMPORTANT SAFETY INSTRUCTIONS READ ALL WARNINGS AND INSTRUCTIONS BEFORE USING THIS PRODUCT. SAVE THESE INSTRUCTIONS.

#### ⚠ WARNING

TO REDUCE THE RISK OF ELECTROCUTION,  
BURNS, OR PRODUCT FAILURE:

1. Injury may result from improper use.
2. This Product is for OUTDOOR USE ONLY.
3. Discontinue use immediately if skin becomes uncomfortably hot.
4. Do NOT use in hot temperatures.
5. Do NOT allow Product to touch bare skin - always cover skin with clothing.
6. Do NOT use while sleeping.
7. Do NOT submerge the Product or any battery pack in water or clean in washing machine.
8. Follow all manufacturer's warnings and instructions regarding the use of any battery product used when operating this Product.
9. ZIPPO will not be responsible or liable for any damages you or any third party may suffer as a result of use or misuse of this Product.
10. Any changes or modifications not expressly approved by ZIPPO may void your authority to operate this equipment.

**NOTE:** This equipment has been tested and found to comply with the limits for a Class B digital device, pursuant to part 15 of the FCC Rules. These limits are designed to provide reasonable protection against harmful interference in a residential installation. This equipment generates, uses and can radiate radio frequency energy and, if not installed and used in accordance with the instructions, may cause harmful interference to radio communications. However, there is no guarantee that interference will not occur in a particular installation. If this equipment does cause harmful interference to radio or television reception, which can be determined by turning the equipment off and on, the user is encouraged to try to correct the interference by one or more of the following measures:

- Reorient or relocate the receiving antenna.
- Increase the separation between the equipment and receiver.
- Connect the equipment into an outlet on a circuit different from that to which the receiver is connected.
- Consult the dealer or an experienced radio/TV technician for help.

## OPERATION FEATURES

1. Seat Pad
2. Backrest Pad
3. Carry Handle(s)
4. Pocket for battery power source (on back)
5. Seat & Backrest Control Buttons
6. USB-A Plug (on back)
7. USB-A Cover (on back)
8. Power source (not included, Zippo® HeatBank® Recommended)

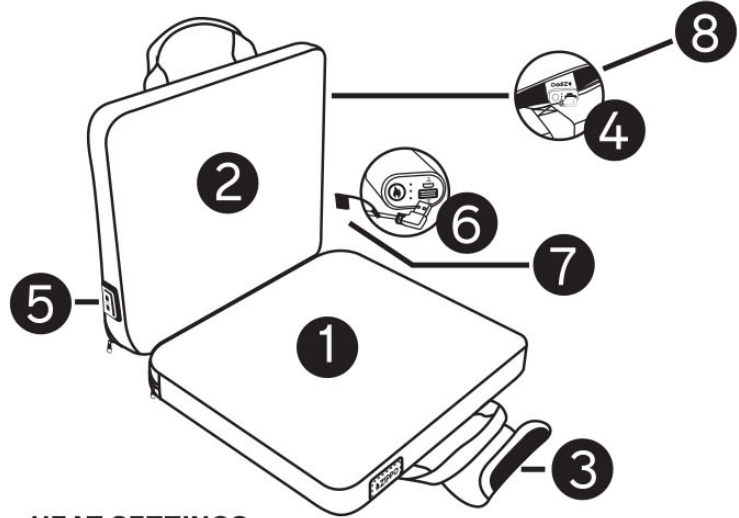

### HEAT SETTINGS

AS INDICATED ON THE SEAT CONTROL BUTTON:

- LOW= Blue light
- MED= White light
- HIGH = Red light



### POWER ON:

1. Plug the USB-A cable into a battery power source. (Zippo HeatBank recommended)
2. Once connected, the LED lights on the Seat Control Button will cycle through the 3 colors listed above.
3. Press and hold each Seat Control Button to turn on the Product.
  - A. Each zone must be independently turned ON/ OFF.
  - B. Each zone will start in the HIGH heat setting (red light).

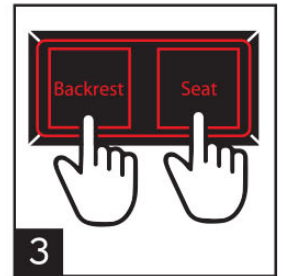
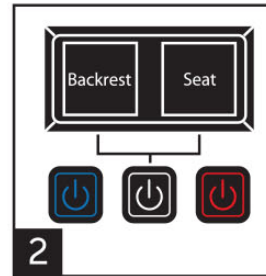
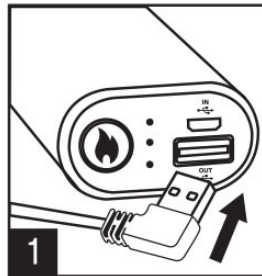

4. Each press of the Button will decrease the temperature one level and cycle thru the following settings:
  - A. RED Light High (initial setting) > MEDIUM > LOW
5. Repeatedly press Button to cycle to the next desired setting.
6. Place the battery power source into the pocket.

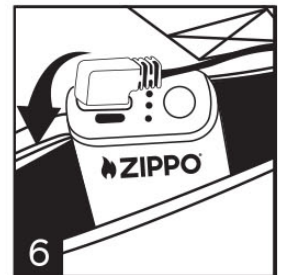
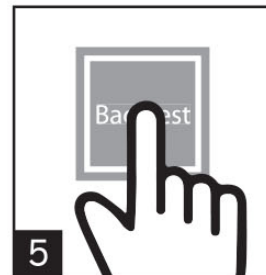

## POWER OFF:

7. Press and hold Seat Control Button until the LED indicator light turns OFF.



## PRODUCT WAKE UP:

8. If the Product has been plugged into a battery power source without using heating, you may need to wake up the Product by either:
  - A. PRESS and HOLD the Seat Control Button until the lights cycle thru the 3 LED indicator colors. or:
  - B. UNPLUG and PLUG back into your battery power source.

## CLEANING:

9.
  - Wipe clean with a damp cloth.
  - Do NOT submerge in water.

## WARRANTY

### 1 YEAR LIMITED WARRANTY

Terms and conditions:

#### WHAT IS COVERED

- Zippo Manufacturing Company warrants the Product against manufacturing defects in material and workmanship under normal use.
- Warranty coverage extends to the original purchaser and begins on the date of purchase and ends one (1) year thereafter.

#### WHAT IS NOT COVERED

- This warranty does not cover, and Zippo shall have no liability with respect to, damage, failure or loss caused by or attributable to abuse, accident, misuse, improper or abnormal use, neglect, improper or unauthorized repair, failure to follow instructions provided by Zippo, or "acts of God" or other contingencies beyond the control of Zippo.
- Incidental or consequential damages, although some states do not allow the exclusion or limitation of incidental or consequential damages, so the above limitation or exclusion may not apply to you.

## SUPPORT

### ZIPPO CONSUMER RELATIONS

- THANK YOU FOR PURCHASING THIS ZIPPO PRODUCT.
- If you have any questions, contact Zippo Consumer Relations at;
- In the U.S.
  - Chat: [www.zippo.com](http://www.zippo.com)
  - Support: [www.zippo.com/support](http://www.zippo.com/support)
  - Email: [CR@Zippo.com](mailto:CR@Zippo.com)
  - Phone: 1-888-442-1932  
Mon.-Fri. 8a-5p EST

### ONLINE SUPPORT

- For online help, general tips, videos, and useful information about Zippo Product: [www.zippo.com/support](http://www.zippo.com/support)

### MANUFACTURER INFORMATION

- Zippo Manufacturing Company  
33 Barbour Street Bradford, PA 16701 USA  
[www.zippo.com](http://www.zippo.com)