



## HeatBank™ 6 Rechargeable Hand Warmer

Instructions  
6: Model #Z4A20  
English USA – en

© Zippo Manufacturing Company 2020\_rA



Thank you for purchasing the Zippo® HeatBank 6 hand warmer ("Product"). **READ ALL WARNINGS AND INSTRUCTIONS** before using your Product for the first time. Improper use of this Product may result in Product damage, excess heat, toxic fumes, fire or explosion, for which damages you ("Purchaser") and not Zippo Manufacturing Company ("Zippo") are responsible.

If you have any problems with the operation of your Product, **DO NOT return it to the retail store.** Instead, consumers in the U.S. should contact Zippo Consumer Relations at 1-888-442-1932 or visit [www.zippo.com](http://www.zippo.com).

**⚠ WARNING:** Read all safety warnings and instructions. Failure to follow the warnings and instructions may result in electric shock, fire and/or serious injury. Save these instructions for future reference.

### GENERAL SAFETY WARNINGS AND INSTRUCTIONS

- Failure to follow all instructions may result in electric shock, fire and/or serious injury.
- The Product batteries are designed to work in temperatures between -4°F and 120°F (-20°C and 49°C). The Product can be damaged and battery life shortened if stored or operated outside of these temperatures.
- DO NOT expose battery to intense heat or dispose in a fire as this may result in an explosion.
- DO NOT expose to intense sunlight or temperatures above 120°F (49°C).
- DO NOT expose to moisture or submerge in liquid.
- Not intended for children.
- Be cautious of excessive drops, bumps, abrasions or other impacts to this Product. If there is any damage to the Product such as dents, punctures, tears, deformities or corrosion, due to any cause, discontinue use and dispose of it properly as outlined in the Safe Battery Disposal section in this manual.
- DO NOT disassemble this Product or attempt to repair or modify it in any manner.
- DO NOT attempt to charge Product using any method, apparatus or connection other than the included charging cable to avoid the potential for overheating, leaking, or explosion.
- If the Product is excessively hot, is emitting odor, becomes deformed, damaged, or demonstrates abnormal operation, immediately discontinue use and contact Zippo.
- Fully charge your Product prior to any extended storage.
- All batteries lose energy from self-discharge over time, especially at higher temperatures. When the Product is not in use, we recommend that the battery is charged at least every three (3) months.

**IMPORTANT:** Use only with Listed/Certified ITE Power Supply.

### DISCLAIMER:

Zippo will not be responsible or liable for any damages you or any third party may suffer as a result of use or misuse of this Product. This device complies with part 15 of the FCC Rules. Operation is subject to the following two conditions:

- (1) This device may not cause harmful interference, and (2) this device must accept any interference received, including interference that may cause undesired operation.

**NOTE:** This equipment has been tested and found to comply with the limits for a Class B digital device, pursuant to part 15 of the FCC Rules. These limits are designed to provide reasonable protection against harmful interference in a residential installation. This equipment generates, uses and can radiate radio frequency energy and, if not installed and used in accordance with the instructions, may cause harmful interference to radio communications. However, there is no guarantee that interference will not occur in a particular installation. If this equipment does cause harmful interference to radio or television reception, which can be determined by turning the equipment off and on, the user is encouraged to try to correct the interference by one or more of the following measures:

1. Reorient or relocate the receiving antenna.
2. Increase the separation between the equipment and receiver.
3. Connect the equipment into an outlet on a circuit different from that to which the receiver is connected.
4. Consult the dealer or an experienced technician for help.

**CAUTION:** Any changes or modifications not expressly approved by Zippo could void the user's authority to operate the equipment.

### ONE YEAR LIMITED WARRANTY

Zippo Manufacturing Company warrants the Product against manufacturing defects in material and workmanship under normal use. This warranty does not cover, and Zippo shall have no liability with respect to, damage, failure or loss caused by or attributable to abuse, accident, misuse, improper or abnormal use, neglect, improper or unauthorized repair, failure to follow instructions provided by Zippo, or "acts of God" or other contingencies beyond the control of Zippo. This warranty does not cover incidental or consequential damages, although some states do not allow the exclusion or limitation of incidental or consequential damages, so the above limitation or exclusion may not apply to you.

Warranty coverage extends to the original purchaser and begins on the date of purchase and ends one (1) year thereafter. Other than as to the foregoing, this warranty is in lieu of all other express and implied warranties. Any implied warranties which by law cannot be excluded are limited to this same period. Some states do not allow limitations on how long an implied warranty lasts, so the above limitation may not apply to you. This warranty gives you specific legal rights, and you may also have other rights which vary from state to state.

To obtain proper instructions for service under this limited warranty, refer to repair instructions at [zippo.com](http://zippo.com) or contact Zippo Consumer Relations at [consumerrelations@zippo.com](mailto:consumerrelations@zippo.com) or 1-888-442-1932.

**Do not return the Product to the retail store.** If the Product is covered by the warranty, Zippo will repair or replace the item or will refund the purchase price. Any attempt to open the sealed portions of the Product case by user or any non-approved repair center will void this warranty.

**NOTE:** Proof of purchase is required for warranty service.

ZIPPO MANUFACTURING COMPANY  
33 Barbour Street • Bradford, PA 16701 U.S.A.

1. Main Body & Heating Surface (both sides)
2. Power Button
3. Battery/Temperature Indicator Lights (3 Blue)
4. Large USB Port (OUTPUT to charge other devices)
5. Small Micro USB Port (INPUT to recharge Product)
6. Charging Cable – Large USB end
7. Charging Cable – Small Micro USB end

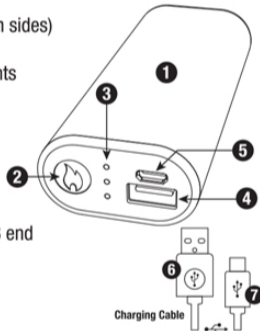

### OPERATING INSTRUCTIONS

#### Power Level Check When powered OFF

Briefly tap POWER button once and release. The BLUE lights will indicate the power status.

- 3 lights indicate a full charge.
- 1 light indicates a low charge and Product should be recharged.

#### When powered ON

BLUE lights will continuously indicate heat status (see above).

#### Temperature Mode

Each side of the Product contains a heating element that can be operated together or independently.

#### To turn the Product ON:

- Press and hold POWER button for 5 seconds to turn unit ON. The Product will power on in the LOW (SINGLE BLUE LIGHT) temperature setting.
- Each press of the POWER button will increase the temperature setting one level.
  - 1 light = LOW heat setting.
  - 2 lights = MEDIUM heat setting.
  - 3 lights = HIGH heat setting.
- Press POWER to cycle the Product through the following settings:
  - BLUE Lights: LOW (initial setting) > MEDIUM > HIGH
- Repeatedly press POWER to cycle to the next desired setting.
- Prolonged contact with skin will reduce operating time and temperature.

**TIP:** To achieve maximum temperature, power ON the Product indoors before going outside. Powering ON outside in excessively cold or windy conditions may reduce performance.

**TIP:** To maximize operating time, it is recommended to use this Product within a clothing pocket. Operating time may be reduced when directly exposed to colder temperatures (outside of a pocket).

#### Powering OFF the Product

Press and hold POWER button for 5 seconds to turn unit OFF.

#### Lanyard Installation & Usage

Some Product configurations may include a neck lanyard. If included, push the small end of the lanyard thru the hole in the Product until contact with the plastic clip is made (Fig A).

• Feed the opposite larger end of the lanyard thru the smaller loop sticking out to form a self-tightening loop (Fig B).

• Continue feeding the lanyard thru until only the small diameter thread is touching the Product (Fig C).

• Slide toggle to back of lanyard. Place lanyard around neck.

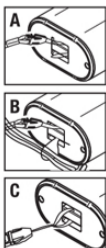

**TIP:** For optimum comfort, adjust the height of the Product on your body by adjusting the toggle. The toggle should be placed behind the neck when worn correctly.

### Recharging the Product

The Product is shipped with a partial charge and MUST be fully charged before using the first time. Use ONLY the charging cable provided with your Product to avoid the potential for overheating, leaking, or explosion. Follow the charging instructions below carefully.

- Plug the small Micro USB end of the charging cable (included) into the small USB port. Plug the large USB end into a suitable charging device or Listed/Certified ITE Power Supply. Charging will begin automatically.
- BLUE indicator lights will blink to show the power level while charging:
  - 3 lights indicate a full charge
  - 1 light indicates a low charge
    - Lower light will blink indicating a low charge
- Periodically inspect the condition of the charging cable. Do not attempt to charge the Product if the charging cable is damaged. Contact Zippo for replacement options if your cable has become worn or broken.
- After charging/recharging, disconnect the charging cable.
- When disconnecting the cord, be sure to pull by plug rather than cord to reduce the risk of damage.
- Place charging cable so it does not become entangled or become a safety hazard.
- Keep charging cable away from sharp edges.

**NOTE:** When using a vehicle's 12 volt DC accessory outlet as a charging source, be aware that some vehicles require you to turn on the ignition to power the accessory outlet. Refer to your vehicle's owner's manual.

### Charging a Mobile Device

- Ensure that the mobile device is appropriate for use with this Product.
- Connect the large USB plug of the appropriate mobile device charging cable (not included) into the large USB port. The mobile device should begin to charge automatically. The BLUE Product light(s) will illuminate indicating power status. Upon removing the cable from the mobile device, the Product will automatically power OFF after about 10 seconds.

**NOTE:** While charging a mobile device, Product heat functions are disabled to prevent overheating. Remove device charging cable (not included) to allow heat functions to resume.

### Safe Battery Disposal

- Never dispose of batteries in the garbage. Disposal of batteries in the garbage is unlawful in the United States, under state and federal environmental laws and regulations. This symbol indicates that the equipment must NOT be thrown into general waste but should be collected separately and properly recycled under local regulations.
- All rechargeable batteries will degrade over time, eventually limiting the battery's ability to retain a charge. This Product contains a lithium ion rechargeable battery pack, which must be disposed of properly when it will no longer retain a charge.
- For information on recycling this battery:
  - Call2Recycle: Call 1-800-822-8837 or visit [www.call2recycle.org](http://www.call2recycle.org).
  - Zippo Consumer Relations: Call 1-888-442-1932 or visit [www.zippo.com](http://www.zippo.com).
  - Contact local, county, or state recycling centers for information on proper disposal.

