



2-Hour Rechargeable Hand Warmer Instructions

English USA – en
Model #Z4B16

Thank you for purchasing the Zippo® 2-Hour Rechargeable Hand Warmer. **READ ALL WARNINGS AND INSTRUCTIONS** before using your Hand Warmer for the first time. Improper use of this product may result in product damage, excess heat, toxic fumes, fire or explosion, for which damages you (“Purchaser”) and not Zippo Manufacturing Company (“Zippo”) are responsible.

If you have any problems with the operation of your Zippo Rechargeable Hand Warmer, **DO NOT return it to the retail store.** Instead, consumers in the U.S. should contact Zippo Consumer Relations at 814-368-2700 or visit www.zippo.com.

⚠ WARNING: Read all safety warnings and instructions. Failure to follow the warnings and instructions may result in electric shock, fire and/or serious injury.

GENERAL SAFETY WARNINGS AND INSTRUCTIONS

- Failure to follow all instructions may result in electric shock, fire and/or serious injury.
- Do not expose battery to intense heat or dispose in a fire as this may result in an explosion.
- Do not expose to intense sunlight or temperatures above 120°F (49°C).
- Do not expose to moisture or submerge in liquid.
- Not intended for children.
- Be cautious of excessive drops, bumps, abrasions or other impacts to this Hand Warmer. If there is any damage to the Hand Warmer such as dents, punctures, tears, deformities or corrosion, due to any cause, discontinue use and dispose of it properly as outlined in the Safe Battery Disposal section in this manual.
- Do not disassemble this Hand Warmer or attempt to repair or modify it in any manner.
- Do not attempt to charge Hand Warmer using any method, apparatus or connection other than the included charging cable to avoid the potential for overheating, leaking, or explosion.
- If the Hand Warmer is excessively hot, is emitting odor, becomes deformed, damaged, or demonstrates abnormal operation, immediately discontinue use and contact Zippo.
- Fully charge your Hand Warmer prior to any extended storage.
- All batteries lose energy from self-discharge over time, especially at higher temperatures. When the Hand Warmer is not in use, we recommend that the battery is charged at least every three (3) months.

IMPORTANT: Use only with Listed/Certified ITE Power Supply.

DISCLAIMER:

Zippo will not be responsible or liable for any damages you or any third party may suffer as a result of use or misuse of this Hand Warmer.

This device complies with part 15 of the FCC Rules. Operation is subject to the following two conditions:

- (1) This device may not cause harmful interference, and (2) this device must accept any interference received, including interference that may cause undesired operation.

NOTE: This equipment has been tested and found to comply with the limits for a Class B digital device, pursuant to part 15 of the FCC Rules. These limits are designed to provide reasonable protection against harmful interference in a residential installation. This equipment generates, uses and can radiate radio frequency energy and, if not installed and used in accordance with the instructions, may cause harmful interference to radio communications. However, there is no guarantee that interference will not occur in a particular installation. If this equipment does cause harmful interference to radio or television reception, which can be determined by turning the equipment off and on, the user is encouraged to try to correct the interference by one or more of the following measures:

1. Reorient or relocate the receiving antenna.
2. Increase the separation between the equipment and receiver.
3. Connect the equipment into an outlet on a circuit different from that to which the receiver is connected.
4. Consult the dealer or an experienced technician for help.

CAUTION: Any changes or modifications not expressly approved by Zippo could void the user's authority to operate the equipment.

WARRANTY

Limited Warranty – 1 year on materials and workmanship, except battery, of the Zippo® Rechargeable Hand Warmer. Normal wear and tear, fading or finish, battery misuse or abuse, and use contrary to instructions are excluded. Any attempt to open the sealed portions of the Hand Warmer case by user or any non-approved repair center will void this warranty. Zippo will repair or replace with same or similar product at Zippo's discretion. This warranty is only valid with the presentation of the original sales receipt. Any implied warranties which by law cannot be excluded are limited to this same period. Some states do not allow limitations on how long an implied warranty lasts, so the above limitation may not apply to you. This warranty gives you specific legal rights which are in addition to, but run concurrently with, any other legal rights which you may have under the statutes of state, province or country, and does not limit those statutory rights. Other than as to the foregoing, this warranty is in lieu of all other express and implied warranties. To obtain service under this limited warranty, consumers should contact Zippo Consumer Relations at 814-368-2700 or visit www.zippo.com.

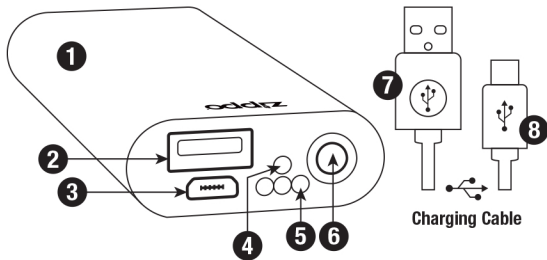

1. Main Body & Heating Surface (both sides)
2. Large USB Port (OUTPUT to charge other devices)
3. Small Micro USB Port (INPUT to recharge Hand Warmer)
4. Temperature Indicator Light (1 Red)
5. Battery Indicator Lights (3 Blue – Low / Medium / High)
6. Power Button
7. Charging Cable – Large USB end
8. Charging Cable – Small Micro USB end

OPERATING INSTRUCTIONS

Power Level Check

When powered OFF

Press POWER button one time. The BLUE lights will indicate the power status.

- 3 lights indicate a full charge.
- 1 light indicates a low charge and Hand Warmer should be recharged.

When powered ON

BLUE lights will continuously indicate power status (see above).

Temperature Mode

- Press and hold POWER button for 5 seconds to turn unit ON. The Hand Warmer will power on in LOW temperature setting.
- Press POWER button to change the temperature setting.
- How quickly the RED light blinks will indicate the temperature setting:
 LOW Setting = SLOW blink (approx. 1 second interval)
 HIGH Setting = FAST blink (approx. 0.5 second intervals)

Powering OFF the Hand Warmer

Press and hold POWER button for 5 seconds to turn unit OFF.

Recharging the Hand Warmer

The Hand Warmer is shipped with a partial charge and MUST be fully charged before using the first time. Use ONLY the charging cable provided with your Hand Warmer to avoid the potential for overheating, leaking, or explosion. Follow the charging instructions below carefully.

- Plug the small Micro USB end of the charging cable (included)

charging device or Listed/Certified ITE Power Supply. Charging will begin automatically.

- BLUE indicator lights will blink to show the power level while charging:
 3 lights indicate a full charge
 1 light indicates a low charge
- Periodically inspect the condition of the charging cable. Do not attempt to charge the Hand Warmer if the charging cable is damaged. Contact Zippo to purchase a replacement if your cable has become worn or broken.
- After charging/recharging, disconnect the charging cable.
- When disconnecting the cord, be sure to pull by plug rather than cord to reduce the risk of damage.
- Place charging cable so it does not become entangled or become a safety hazard.
- Keep charging cable away from sharp edges.

NOTE: When using a vehicle's 12 volt DC accessory outlet as a charging source, be aware that some vehicles require you to turn on the ignition to power the accessory outlet. Refer to your vehicle's owner's manual.

Charging a Mobile Device

- Ensure that the mobile device is appropriate for use with this charger.
- Connect the large USB plug of the appropriate mobile device charging cable (not included) into the large USB port. The mobile device should begin to charge automatically. The BLUE Hand Warmer light(s) will illuminate indicating power status. Upon removing the cable from the mobile device, the Hand Warmer will automatically power OFF after about 10 seconds.

NOTE: While charging a mobile device, Hand Warmer heat functions are disabled to prevent overheating. Remove device charging cable (not included) to allow heat functions to resume.

Safe Battery Disposal

- Never dispose of batteries in the garbage. Disposal of batteries in the garbage is unlawful in the United States, under state and federal environmental laws and regulations.
- All rechargeable batteries will degrade over time, eventually limiting the battery's ability to retain a charge. This unit contains a lithium polymer rechargeable battery pack, which must be disposed of properly when it will no longer retain a charge.
- For information on recycling this battery:
 - Call2Recycle:
 - Call (800) 822-8837 or visit www.call2recycle.org
 - Zippo Consumer Relations:
 - Call 814-368-2700 or visit www.zippo.com.
 - Contact local, county, or state recycling centers for information on proper disposal.

